

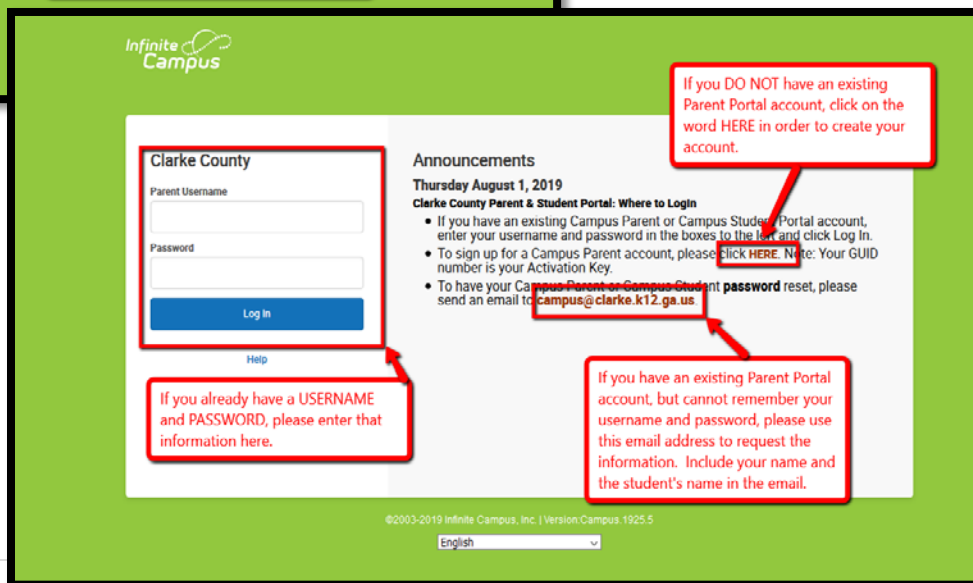

Parent Portal Login

Set up a *NEW* Account

Step 1 Create Account via website

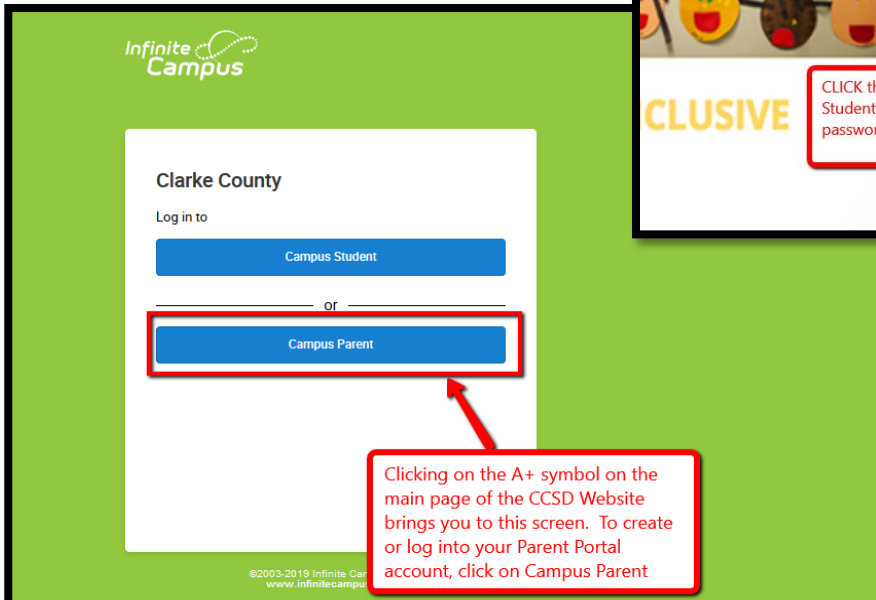
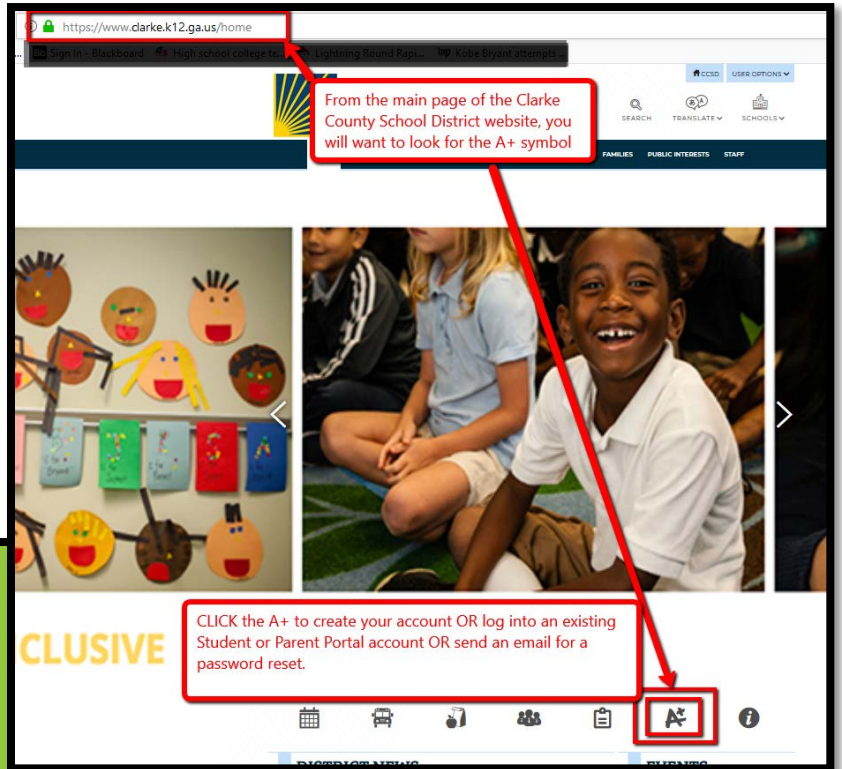

Campus Portal

Last 4 Digits of Student SSN

Student Birthdate

In order to create your Parent Portal account, please enter the last 4 digits of the student's Social Security Number and the student's Date of Birth in the 11/11/1111 format. If you did not provide one or your student does not have a SSN, please contact your student's school. A substitute number was issued at registration and can be obtained for Portal registration.

Name	Username/Activation Key
Ge [REDACTED] Go [REDACTED]	Username: ger [REDACTED]
[REDACTED]	GUID: 75335618-4AE2-4D3E-[REDACTED]

Manually Enter Activation Key

After entering the student's DOB and SSN you will see anyone who is marked in Campus as a Parent/Legal guardian for the student. If the Parent/Legal Guardian has an existing Parent Portal account, the USERNAME will be present as seen here. Make note of it and return to the log in page. Email for your password to be reset if you do not remember it.

If the Parent/Legal Guardian does not have an existing account, the GUID#/Activation Key will be present as seen here. Please write down that Key and click on the MANUALLY ENTER ACTIVATION KEY box. This step returns you to the screen where you choose Campus Student or Campus Parent. CHOOSE CAMPUS PARENT.

Campus Parent

Clarke County

Parent Username

Password

[Help](#)

[Log in to Campus Student](#)

or [New User?](#)

If you have your GUID#/Activation Key written down so that you can enter it, click on NEW USER

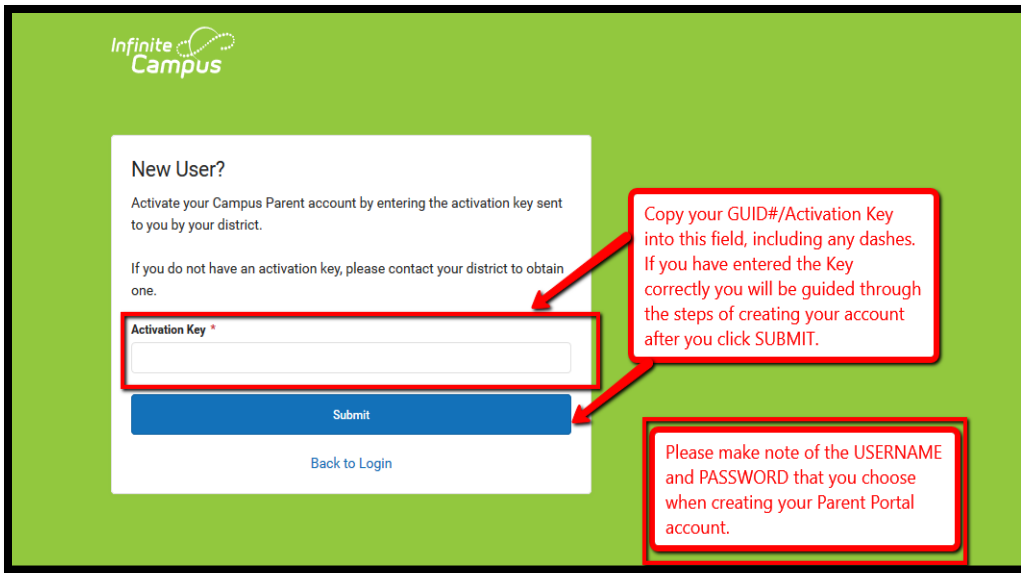

You will be prompted to create a username & password.

Upon logging in, you will see your student's information in a screen similar to this:

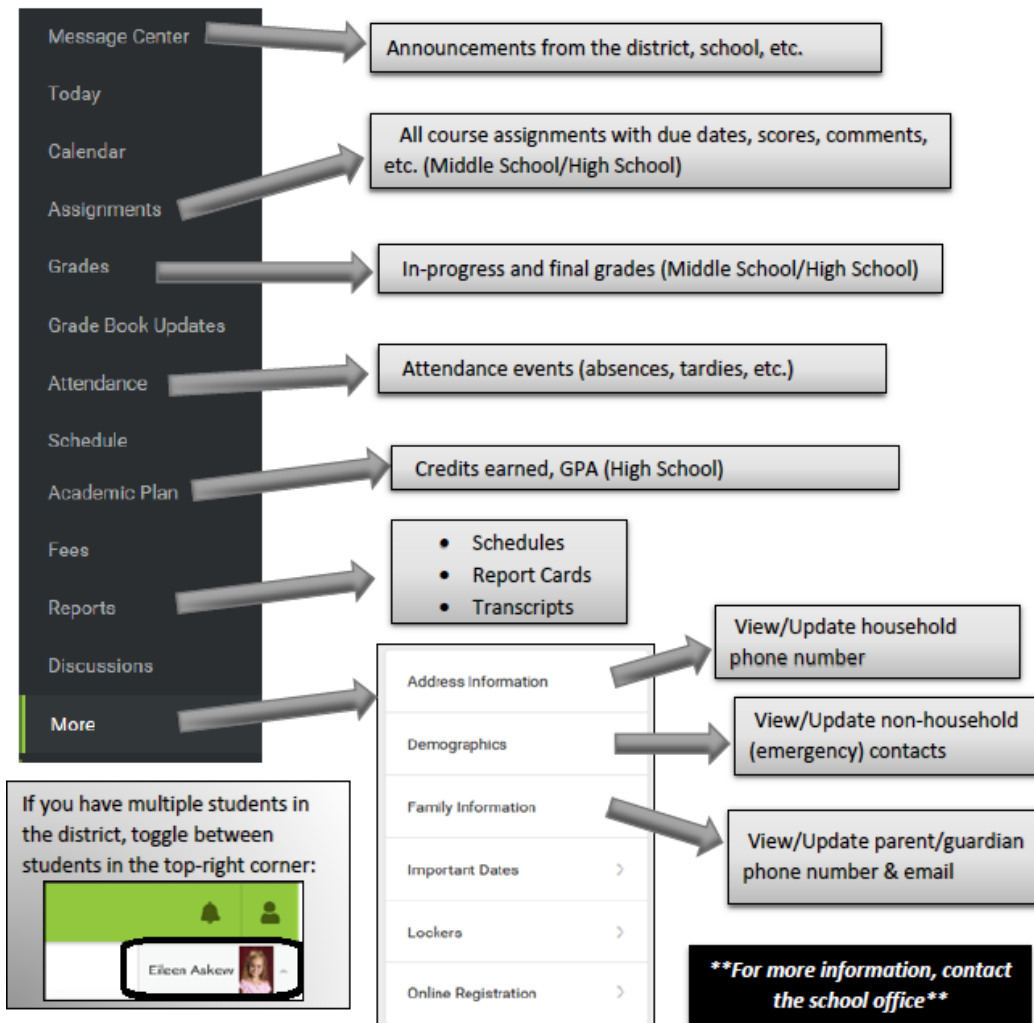

Step 2

Download App in your Mobil



Download the Campus Parent mobile app from the
GOOGLE PLAY STORE or **APPLE STORE**
District Name: **Clarke**

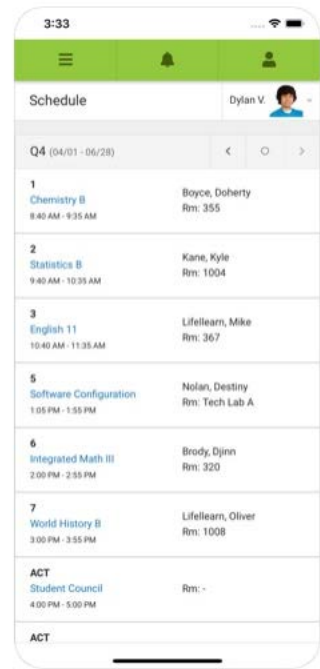
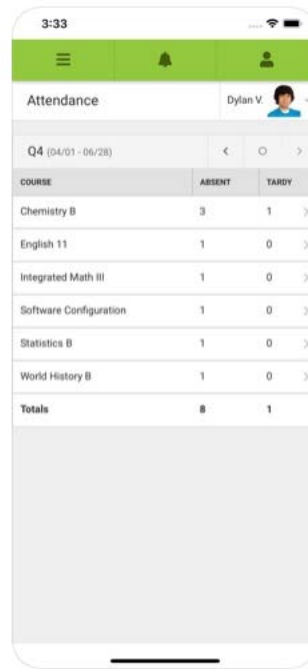

**BAM! You now have Parent Portal
set up on your cell phone 😊**